

fusion

**TRUE WIRELESS
EARBUDS**

 **Bluetooth™**

MANUAL



KLH®
LOVE YOUR MUSIC™

FCC STATEMENT

THIS DEVICE COMPLIES WITH PART 15 OF THE FCC RULES:

Operation is subject to the following two conditions:

1. This device may not cause harmful interference.
2. This device must accept any interference that is received, including any interference that may cause undesired operation.

RF Exposure Warning:

This equipment complies with FCC radiation exposure limits set forth for an uncontrolled environment. This equipment shall be installed and operated with minimum distance 20cm between radiator and body. This device is acting as slave and operating in the 2.4 GHz (2412 -2462 MHz) band. Ad Hoc function is supported but not able to operate on non-US frequencies. Do not use the device with the environment which below minimum -30°C or maximum over 50°C.

NOTE: This equipment has been tested and found to comply with the limits for a Class B digital device, pursuant to part 15 of the FCC Rules. These limits are designed to provide reasonable protection against harmful interference in a residential installation. This equipment generates uses and can radiate radio frequency energy and, if not installed and used in accordance with the instructions, may cause harmful interference to radio communications. However, there is no guarantee that interference will not occur in a particular installation. If this equipment does cause harmful interference to radio or television reception, which can be determined by turning the equipment off and on, the user is encouraged to try to correct the interference by one or more of the following measures:

- Reorient or relocate the receiving antenna.
- Increase the separation between the equipment and receiver.
- Connect the equipment into an outlet on a circuit different from that to which the receiver is connected.
- Consult the dealer or an experienced radio/TV technician for help.

RF exposure warning :

This equipment complies with FCC radiation exposure limits set forth for an uncontrolled environment. This equipment shall be installed and operated with minimum distance 20cm between the radiator & body. Changes or modifications to this unit not expressly approved by the party responsible for compliance could void the user's authority to operate the equipment.

SAFETY INSTRUCTIONS FOR LITHIUM RECHARGEABLE BATTERIES

WARNING

While the FUSION True Wireless Earbuds are built from durable materials, abuse or misuse may cause the lithium batteries to leak, and in extreme cases, damaged headphones may present a risk of explosion, combustion, heat generation, smoke or harmful gas.

PACKAGE CONTENT

- 1 Fusion True Wireless Earbuds.
- 2 USB-C to USB-A Adapter.
- 3 Carrying/Charging case.
- 4 USB-C to USB-C Charging Cord.
- 5 Seven pairs of ear tips: One set of medium eartips are pre-installed on FUSION earbuds.

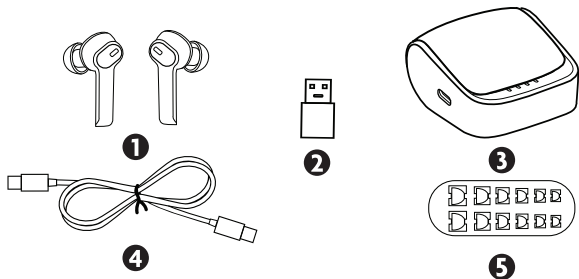

SETUP AND OPERATION

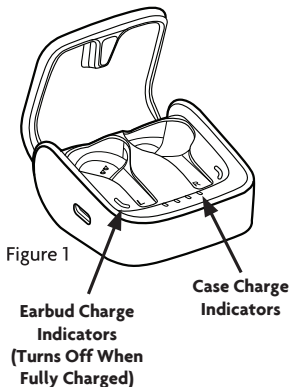

The built-in LED display indicates the percentage of charge left in the case when detached from the charger. A fully charged case offers up to 3 additional charges. Earbud LEDs indicate that earbuds are charging and turn off when fully charged (Figure 1).

A full earbud charge takes approximately 90 minutes. Fully charged earbuds will have up to 7 hours of playing time. Earbuds are magnetically secured to the inside of the case to ensure proper contact with charger.

CHARGING

Figure 2

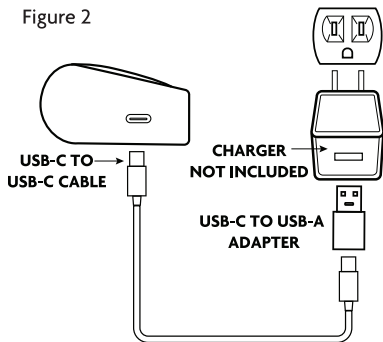

The FUSION case should carry an initial charge, however, if case charge is low, then charge case and earbuds using the included USB-C to USB-C cable (and USB-C TO USB-A adapter if needed) for 5-10 minutes. Do not take the earbuds out during this time. The USB cable can be attached to either a wall charging unit or computer (Figure 2).

The Fusion charging case is capable of wireless charging. Wirelessly charge your device using a Qi certified charge pad or supported device (Figure 3).

Figure 3

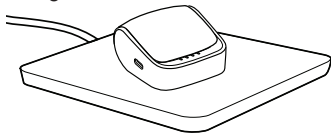

HOW TO OPERATE

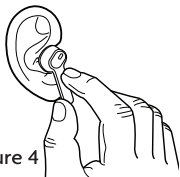

Figure 4

Start by removing the earbuds from their case. This will automatically turn them **ON** and resets the earbuds to their default condition. Insert each earbud into the ear canal (each earbud is labeled L for Left, R for Right), and adjust until upper portion fits comfortably into concha (Figure 4). If factory applied medium silicone tips do not fit, change to the other provided ear tips until properly sealed and a comfortable fit is achieved (Figure 5).

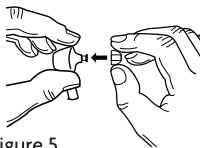

Figure 5

PAIRING

The right and left earbuds can both work separately as a single mono earbud, or use together as a pair of stereo earphones (Stereo).

Be sure the FUSION True Wireless Earbuds and your Bluetooth device are within approximately three feet of one another. Register both devices (earbuds and Bluetooth device) via the device settings of your Bluetooth device. This process is called pairing. The earbuds will appear in your Bluetooth functions as "KLH FUSION". (Figure 6).

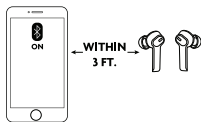

Figure 6

Once connected, your device should display a Message: KLH FUSION (L/R) would like to pair with your device. Press "Pair" to accept the request.

If this is different from the steps mentioned, refer to the instruction manual of the Bluetooth device you are using.

USING YOUR EARBUDS

GENERAL OPERATION

- Some mobile devices will display earbud battery level on status bar near Bluetooth indicator.

MUSIC AND PHONE CONTROL

- Quick touch each earbud to power ON.
- Long touch either earbud for 7 seconds to turn OFF.
- Triple touch either earbud to pause.
- Triple touch either earbud to resume play.
- Double touch either earbud to track forward.
- Quick touch either earbud four times to track back.
- Double touch either earbud to accept call.
- Long press either earbud for 2 seconds to reject call.
- Long press either earbud for 2 seconds to access voice assistant.

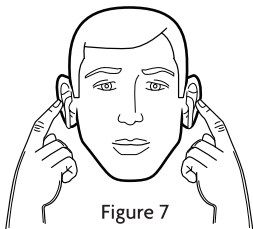

Figure 7

VOICE CONTROL

- “Play music”
- “Pause music”
- “Previous song”
- “Next song”
- “Accept call”
- “Reject call”
- “Volume Up”
- “Volume Down”
- “Hey SIRI”

ACCEPTING, REJECTING, OR ENDING A CALL

If your earbuds are connected to a smartphone and you receive a call, you will hear a ring tone in the earbuds. If you are playing music when you receive a call, the music will pause until you end the call.

CARE AND CLEANING

To care for your KLH FUSION True Wireless Earbuds, simply clean with a soft, dry cloth, avoid using solvents or caustic materials.

WATER RESISTANCE

The KLH FUSION True Wireless Earbuds have a water resistance IPX5 rating, making them perfect for workouts and outdoor activity. **DO NOT SUBMERGE IN WATER.**

Bluetooth Version	Bluetooth 5.0 + aptX
Case Power Cell	600mAH
Earbud Power Cell (per Earbud)	75mAH
Charge Time	90 Minutes
Earbud Battery Life	7 Hours
Frequency Response	20Hz-23kHz
Tranducer Type	Single Dynamic Driver
Driver Size	6mm
Water Resistant Rating	IPX5

OSHA GUIDELINES FOR NOISE EXPOSURE LEVELS

Sound Pressure Level	Recommended Maximum Exposure Per Day
90dB	8 Hours
92dB	6 Hours
95dB	4 Hours
97dB	3 Hours
100dB	2 Hours
102dB	1.5 Hours
105dB	1 Hours
110dB	30 Minutes
115dB	15 Minutes or less
120dB	Avoid as damage may occur

WARRANTY

Our 1 year warranty (2 years in EU) begins from purchase date of the item (Receipt Date). Warranty registration must be completed at KLHAUDIO.com/warranty. Registration of the product must be completed within 60 days of purchase for warranty validation. Original receipt of purchase must be retained for proof of purchase. For warranty or service issues, please DO NOT contact the place of purchase but rather contact KLH Customer Service directly. The warranty covers any production and/or material defects of the product. This warranty is non-transferable.

The following is NOT COVERED by the warranty:

1. Accidents, misuse, poor maintenance, electrical overloads such as lightning or voltage.
2. Incorrect use of product.
3. Purchase of KLH products from unauthorized reseller.

Replacement item cannot exceed the cost of the item under warranty. The supplier is responsible for only repair or replacement. KLH toll free number is 1-833-554-8326.

TROUBLESHOOTING

Once the earbuds are successfully paired to your device, follow these steps in the event one, or both, earbuds lose connection.

The first step is to place both earbuds in the charging case. This will reset both earbuds to their default condition. After a few seconds, remove both earbuds and allow them to automatically pair (or connect) to your device.

If the earbuds fail to automatically pair to your device, go into the mobile device's Bluetooth menu and manually select "KLH FUSION" in the device list. Your device list might include a "KLH FUSION L" and "KLH FUSION R" in the list. Your device is just recognizing both left & right earbuds, and you only have to select one in order for both earbuds to be recognized.

If the above steps are not successful, the easiest solution is to simply go to the Bluetooth menu in your device and select "forget device" to remove "KLH FUSION" from the Bluetooth list. From there, simply follow the setup instructions to re-pair the earbuds to your device. Please consult the "quick start guide" or this manual for that procedure. If you have any additional problems call our toll free number at **1-833-554-8326**.



klhaudio.com